

INSTALLATION INSTRUCTIONS



BRAVO



Important Safety

1. Before installation or maintenance, ensure that the mains supply to the luminaire is switched off and circuit supply fuses are removed or the circuit breaker is turned off.
2. It is recommended that only a qualified electrical contractor carries out the installation of this luminaire and that the luminaire is installed in compliance with the current edition of the IEE wiring Regulations.
3. The person carrying out the installation is to check and verify that the total load on the circuit, including that of this luminaire does not exceed the rating of the circuit cable, fuse or circuit breaker.
4. Where applicable, careful consideration should be taken during installation to ensure that all fixings and/or suspensions are of a suitable size for the luminaire being installed.

Instructions:

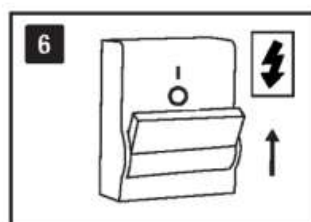
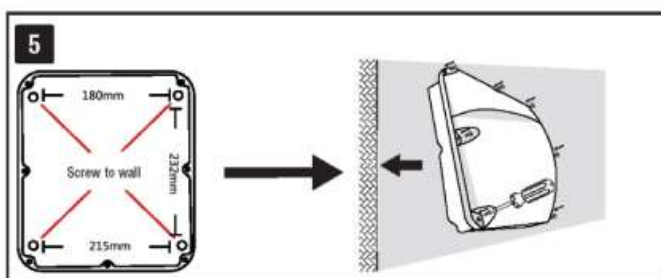
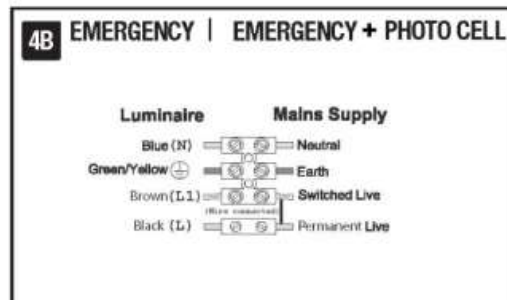
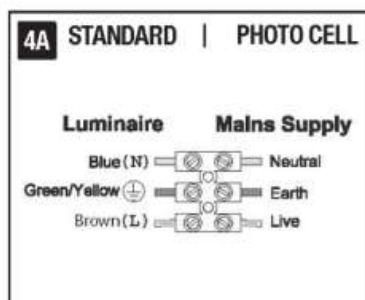
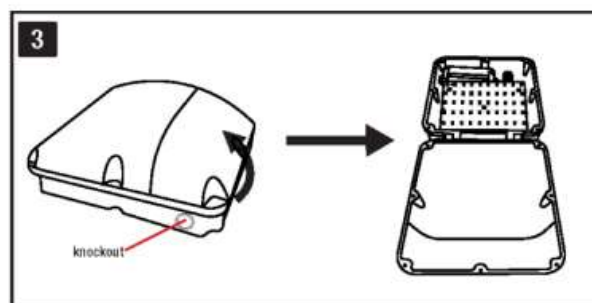
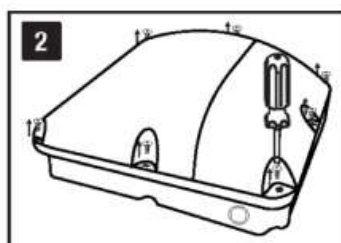
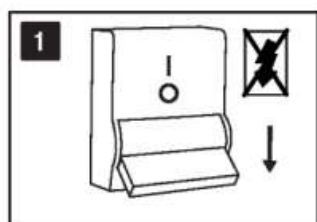





Telephone: +44 (0)1704 512000
Email: info@morganhope.com www.morganhope.com